

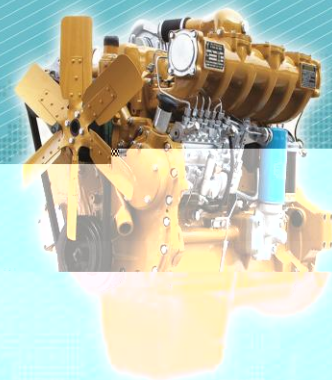

R系列工程机械用柴油机零件图册

R-series parts catalogue for construction machinery application



华丰动力股份有限公司
POWER HF CO., LTD.

华丰动力股份有限公司

地址：江苏省常州市武进区遥观镇华丰工业园
邮编：312100
电话：13905141070
传真：13905141071
网址：http://www.powerhf.com
E-mail: info@powerhf.com

POWER HF CO., LTD.

ADD: 312100 Wujiaochang Road, Wujiaochang Development
Zone, Wujiaochang Town, Suzhou Prefecture, P. R. C.
Phone: 0512-7107070
Mobile: 13905141070
Fax: 13905141071
Website: www.powerhf.com
E-mail: info@powerhf.com

R 系列柴油机零件图册

前 言

R 系列柴油机为四冲程、水冷、直列、直喷 ω 燃烧室高速柴油机，是英国里卡多 (RICARDO) 公司为我国设计并与我公司联合研制的国内同类型柴油机的换代产品。具有良好的动力性、经济性、起动性能。

R Series Diesel Engine Parts Catalogue For Take Off Unit

PREFACER

R series diesel engine is a family of high speed engine of four-stroke, water-cooled, in-line direct injection and ω type chamber. It is a new generation product that designed by RICARDO and developed by RICARDO and Weifang Diesel Engine Limited Company, with good dynamic characteristics, fuel economy as well as excellent starting performance, the reliability and service life of the R series engines have reached the advanced world level among the products of the kind. R series includes 3-, 4 and 6-cylinder with bore of 105mm, 4 and 6-cylinder with bore of 108mm and 110mm, general purpose diesel engines with natural aspiration and turbocharging type. According to the requirements, various versions of R series can be developed by modifying some parts so as to be used for different applications, such as tractors, trucks,

es

2011

2011

2011

2011

目 录 CONTENTS

气缸盖及罩总成

CYLINDER HEAD & COVER ASSEMBLY

图 号

2. 机体总成

5

CYLINDER BLOCK ASSEMBLY

3. 凸轮轴总成

CAMSHAFT ASSEMBLY

图 号

图 号

10. 曲轴箱通风装置总成	
CRANKCASE VENTILATION ASSEMBLY·····	28
11. 空滤器总成	
AIR CLEANER ASSEMBLY·····	31
12. 进气管总成	
AIR INLET MANIFOLD ASSEMBLY·····	34
13. 排气系统总成	
EXHAUST SYSTEM ASSEMBLY·····	37
14. 燃油系统总成	
FUEL SYSTEM ASSEMBLY·····	40
15. 润滑系统总成	
LUBRICATING SYSTEM ASSEMBLY·····	45
16. 冷却系统总成	
COOLING SYSTEM ASSEMBLY·····	49
17. 电器系统总成	
ELECTRICAL SYSTEM ASSEMBLY·····	53
18. 空气压缩机总成	
AIR COMPRESSOR ASSEMBLY·····	57
19. 增压器总成	
TURBOCHARGER ASSEMBLY·····	59
20. 支架底座总成	
BRACKET AND SUPPORT SEAT ASSEMBLY·····	63

气缸盖及罩总成

CYLINDER

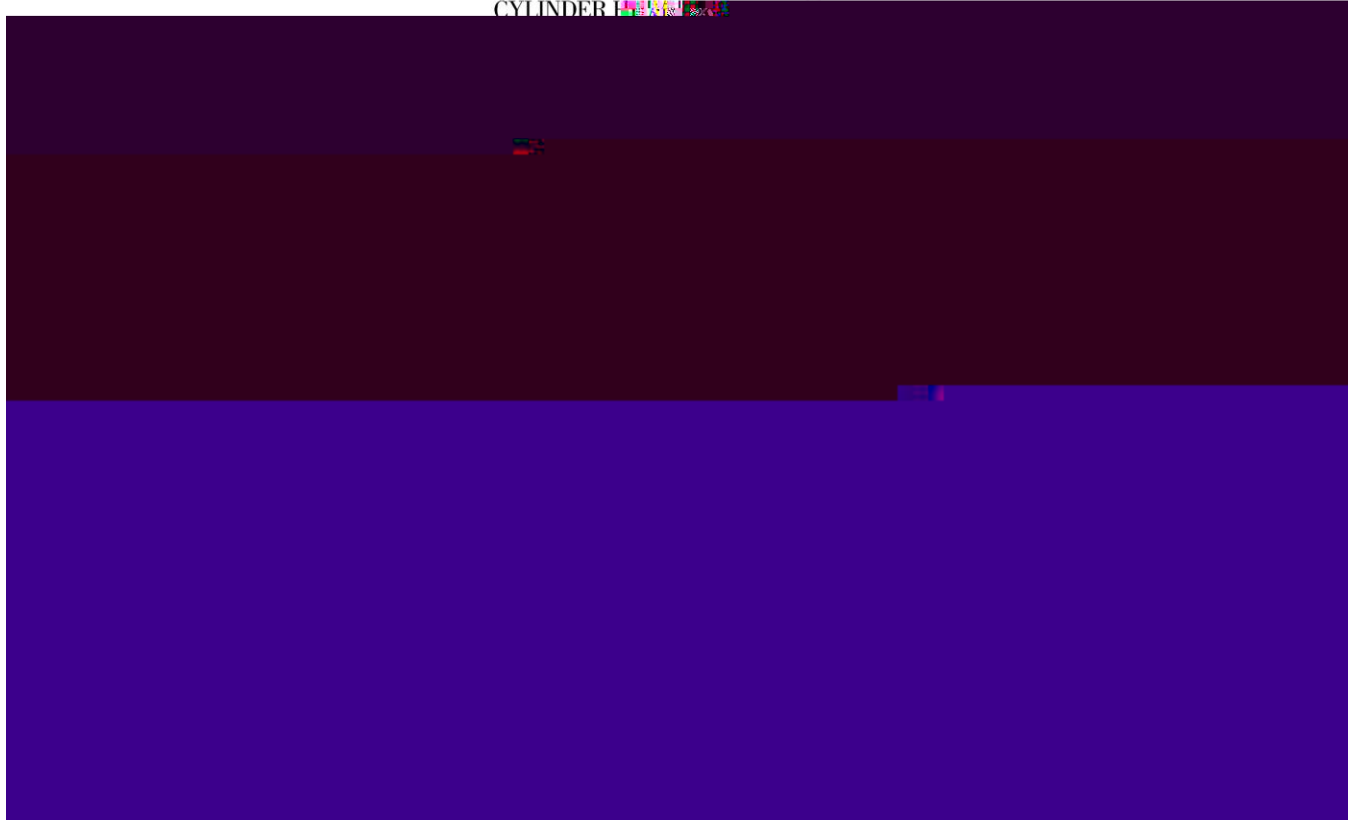

1. 气缸盖及罩总成
CYLINDER HEAD & COVER ASSEMBLY

柴油机型号 Model No.				4RMZC9.25	4RMZC9.25-1	4RMZC9.3	4RMZC9.3	4RMZC9.6	4RMZC9.20
供货号 Delivery No.						QZ2	XG1	QZ2	LZ2
1	R010001Y-1	进气门	Inlet valve	4	4			4	6
	R3010001Y	进气门	Inlet valve				4		
	R5010001	进气门	Inlet valve			4			
2	R010002-1	排气门	Exhaust valve	4	4			4	6
	R3010002Y	排气门	Exhaust valve				4		
	R5010002	排气门	Exhaust valve			4			
3	R010004-1	气门弹簧上座	Valve spring upper retainer	8	8	8	8	8	12
4	R010005	气门锁夹	Valve lock	8	8	8	8	8	12
5	R010006	气门杆护帽	Valve stem cap	8	8	8	8	8	12
6	R010007	气缸盖螺栓	Cylinder head bolt	18	18	18	18	18	26
7	R010008	喷油器压板	Cylinder plate injector	4	4	4	4	4	6
8	R010009-1	吊耳	Lifting ring	2	2	1	2	2	2
	3R010009	吊耳	Lifting ring			1			
9	4R010011-2	气缸盖垫片	Cylinder head gasket	1	1			1	
	6R010011-2	气缸盖垫片	Cylinder head gasket						1
	4R5010011-2	气缸盖垫片	Cylinder head gasket			1			
	4R5010011-2A	气缸盖垫片	Cylinder head gasket				1		
10	R010012	气缸盖螺栓垫圈	Washer, cylinder head bolt	18	18	18	18	18	26

柴油机型号 Model...	4RMZG8	4RMG25-1	4RNSG3	4RNG3	4RMAZG	4RMG20
-------------------	--------	----------	--------	-------	--------	--------



机体总成
CYLINDER BLOCK ASSEMBLY

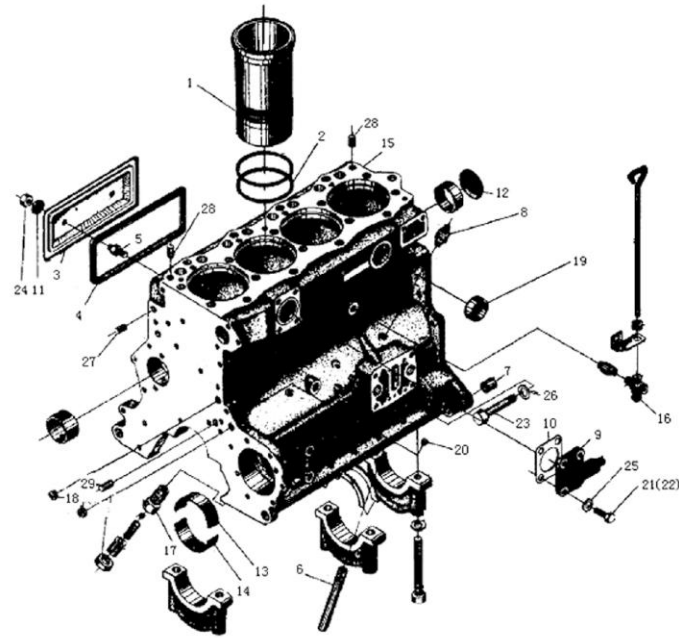

2. 机体总成

CYLINDER BLOCK ASSEMBLY

柴油机型号				4RMZG8	4RMZG14	4RMZG25	4RMZG35	4RMZG3	4RMAZG	6RMZG20
Model										
供货号										
Delivery No.						QZ2	XG1	QZ2	LZ2	
1	R1020001	气缸套	Cylinder liner	4	4			4	6	
	R5020001	气缸套	Cylinder liner			4	4			
2	R1020003	气缸套第二,三槽O型密封圈	"O" seal ring, 2nd & 3rd grooves	12	12	12	12	12	18	
3	4RD020008	前推杆室盖	Front pushrod chamber cover	1	1	1	1	1		
	6R020008-A	前推杆室盖	Front pushrod chamber cover							1
	6R020008	前推杆室盖	Gasket, front pushrod chamber cover							1
4	495-01024(b)	侧盖密封片	Side cover gasket	1	1	1	1	1		
5	R020011-A	推杆室螺钉	Stud, pushrod chamber	4	4	4	4	4	6	
6	R020012	主油压溢流阀回油管	Oil drain tube, overflow valve	1	1	1	1	1		
7	R020015	空心定位销	Hollow dowel pin	2	2	2	2	2	2	
8	4R1ZT2020016	油管接头	Oil pipe adapter	1	1	1	1	1	1	
	R020016-B	油管接头	Oil pipe adapter				1			
	R020016-C	油管接头	Oil pipe adapter					1		
	R020016-D	油管接头	Oil pipe adapter		1					
	6R1C5020016	油管接头	Oil pipe adapter			1				1

柴油机型号对照表			4RMZG8	4RMG25-1	4RNSG3	4RNG3	4RMAZG	6RMG20
Model	Model	Model						
1. 4RMZG8	4RMZG8	4RMZG8	1	1	1	1	1	1
2. 4RMG25-1	4RMG25-1	4RMG25-1	1	1	1	1	1	1
3. 4RNSG3	4RNSG3	4RNSG3	1	1	1	1	1	1
4. 4RNG3	4RNG3	4RNG3	1	1	1	1	1	1
5. 4RMAZG	4RMAZG	4RMAZG	1	1	1	1	1	1
6. 6RMG20	6RMG20	6RMG20	1	1	1	1	1	1
7. 4RMZG8	4RMZG8	4RMZG8	1	1	1	1	1	1
8. 4RMG25-1	4RMG25-1	4RMG25-1	1	1	1	1	1	1
9. 4RNSG3	4RNSG3	4RNSG3	1	1	1	1	1	1
10. 4RNG3	4RNG3	4RNG3	1	1	1	1	1	1
11. 4RMAZG	4RMAZG	4RMAZG	1	1	1	1	1	1
12. 6RMG20	6RMG20	6RMG20	1	1	1	1	1	1
13. 4RMZG8	4RMZG8	4RMZG8	1	1	1	1	1	1
14. 4RMG25-1	4RMG25-1	4RMG25-1	1	1	1	1	1	1
15. 4RNSG3	4RNSG3	4RNSG3	1	1	1	1	1	1
16. 4RNG3	4RNG3	4RNG3	1	1	1	1	1	1
17. 4RMAZG	4RMAZG	4RMAZG	1	1	1	1	1	1
18. 6RMG20	6RMG20	6RMG20	1	1	1	1	1	1
19. 4RMZG8	4RMZG8	4RMZG8	1	1	1	1	1	1
20. 4RMG25-1	4RMG25-1	4RMG25-1	1	1	1	1	1	1
21. 4RNSG3	4RNSG3	4RNSG3	1	1	1	1	1	1
22. 4RNG3	4RNG3	4RNG3	1	1	1	1	1	1
23. 4RMAZG	4RMAZG	4RMAZG	1	1	1	1	1	1
24. 6RMG20	6RMG20	6RMG20	1	1	1	1	1	1
25. 4RMZG8	4RMZG8	4RMZG8	1	1	1	1	1	1
26. 4RMG25-1	4RMG25-1	4RMG25-1	1	1	1	1	1	1
27. 4RNSG3	4RNSG3	4RNSG3	1	1	1	1	1	1
28. 4RNG3	4RNG3	4RNG3	1	1	1	1	1	1
29. 4RMAZG	4RMAZG	4RMAZG	1	1	1	1	1	1
30. 6RMG20	6RMG20	6RMG20	1	1	1	1	1	1

凸轮轴总成
CAMSHAFT ASSEMBLY

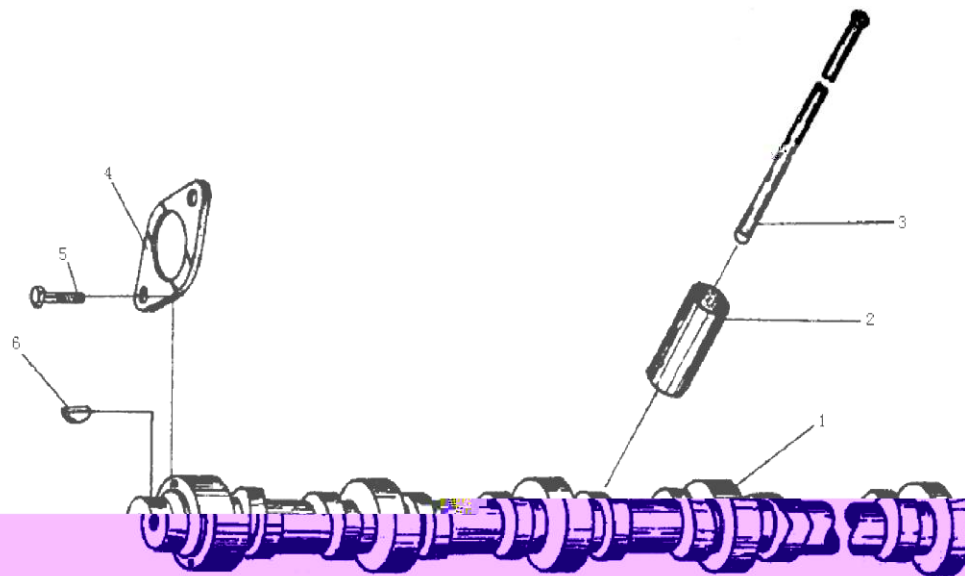

3. 凸轮轴总成
CAMSHAFT ASSEMBLY

柴油机型号 Model				4RMZG8	4RMG25-1	4RNSG3	4RNG3	4RMAZG	6RMG20
供货号 Delivery No.						QZ2	XG1	QZ2	LZ2
1	4R030001Y	凸轮轴	Camshaft	1	1	1	1	1	
	6R030001y	凸轮轴	Camshaft						1
2	R030002	挺柱	Tappet	8	8	8	8	8	12
3	R030003	推杆	pushrod	8	8	8	8	8	12
4	R030004	凸轮轴止推板	Thrust plate,camshaft	1	1	1	1	1	1
5	M8 × 20GB5783	全螺纹六角头螺栓	Full thread hex bolt	2	2	2	2	2	2
6	6 × 22GB1099	半圆键	Woodruff key	1	1	1	1	1	1

曲轴飞轮总成
CRANKSHAFT & FLYWHEEL ASSEMBLY

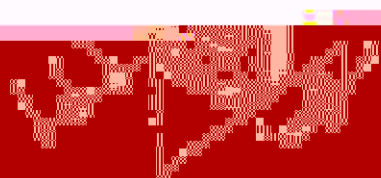
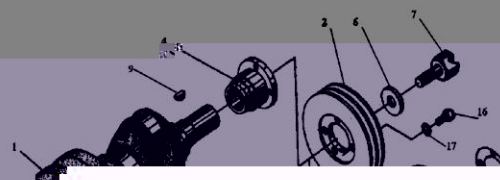

柴油机型号 Model	4RMZG8	4RMC25-1	4RNSG3	4RNG3	4RMAZG	6RMC20
----------------	--------	----------	--------	-------	--------	--------

1. 4RMZG8	4RMZG8	4RMZG8	4RMZG8	4RMZG8	4RMZG8	4RMZG8
2. 4RMC25-1	4RMC25-1	4RMC25-1	4RMC25-1	4RMC25-1	4RMC25-1	4RMC25-1
3. 4RNSG3	4RNSG3	4RNSG3	4RNSG3	4RNSG3	4RNSG3	4RNSG3
4. 4RNG3	4RNG3	4RNG3	4RNG3	4RNG3	4RNG3	4RNG3
5. 4RMAZG	4RMAZG	4RMAZG	4RMAZG	4RMAZG	4RMAZG	4RMAZG
6. 6RMC20	6RMC20	6RMC20	6RMC20	6RMC20	6RMC20	6RMC20
7. 4RMZG8	4RMZG8	4RMZG8	4RMZG8	4RMZG8	4RMZG8	4RMZG8
8. 4RMC25-1	4RMC25-1	4RMC25-1	4RMC25-1	4RMC25-1	4RMC25-1	4RMC25-1
9. 4RNSG3	4RNSG3	4RNSG3	4RNSG3	4RNSG3	4RNSG3	4RNSG3
10. 4RNG3	4RNG3	4RNG3	4RNG3	4RNG3	4RNG3	4RNG3
11. 4RMAZG	4RMAZG	4RMAZG	4RMAZG	4RMAZG	4RMAZG	4RMAZG
12. 6RMC20	6RMC20	6RMC20	6RMC20	6RMC20	6RMC20	6RMC20
13. 4RMZG8	4RMZG8	4RMZG8	4RMZG8	4RMZG8	4RMZG8	4RMZG8
14. 4RMC25-1	4RMC25-1	4RMC25-1	4RMC25-1	4RMC25-1	4RMC25-1	4RMC25-1
15. 4RNSG3	4RNSG3	4RNSG3	4RNSG3	4RNSG3	4RNSG3	4RNSG3
16. 4RNG3	4RNG3	4RNG3	4RNG3	4RNG3	4RNG3	4RNG3
17. 4RMAZG	4RMAZG	4RMAZG	4RMAZG	4RMAZG	4RMAZG	4RMAZG
18. 6RMC20	6RMC20	6RMC20	6RMC20	6RMC20	6RMC20	6RMC20
19. 4RMZG8	4RMZG8	4RMZG8	4RMZG8	4RMZG8	4RMZG8	4RMZG8
20. 4RMC25-1	4RMC25-1	4RMC25-1	4RMC25-1	4RMC25-1	4RMC25-1	4RMC25-1
21. 4RNSG3	4RNSG3	4RNSG3	4RNSG3	4RNSG3	4RNSG3	4RNSG3
22. 4RNG3	4RNG3	4RNG3	4RNG3	4RNG3	4RNG3	4RNG3
23. 4RMAZG	4RMAZG	4RMAZG	4RMAZG	4RMAZG	4RMAZG	4RMAZG
24. 6RMC20	6RMC20	6RMC20	6RMC20	6RMC20	6RMC20	6RMC20
25. 4RMZG8	4RMZG8	4RMZG8	4RMZG8	4RMZG8	4RMZG8	4RMZG8
26. 4RMC25-1	4RMC25-1	4RMC25-1	4RMC25-1	4RMC25-1	4RMC25-1	4RMC25-1
27. 4RNSG3	4RNSG3	4RNSG3	4RNSG3	4RNSG3	4RNSG3	4RNSG3
28. 4RNG3	4RNG3	4RNG3	4RNG3	4RNG3	4RNG3	4RNG3
29. 4RMAZG	4RMAZG	4RMAZG	4RMAZG	4RMAZG	4RMAZG	4RMAZG
30. 6RMC20	6RMC20	6RMC20	6RMC20	6RMC20	6RMC20	6RMC20

活塞连杆总成
PISTON & CONNECTING ROD ASSEMBLY

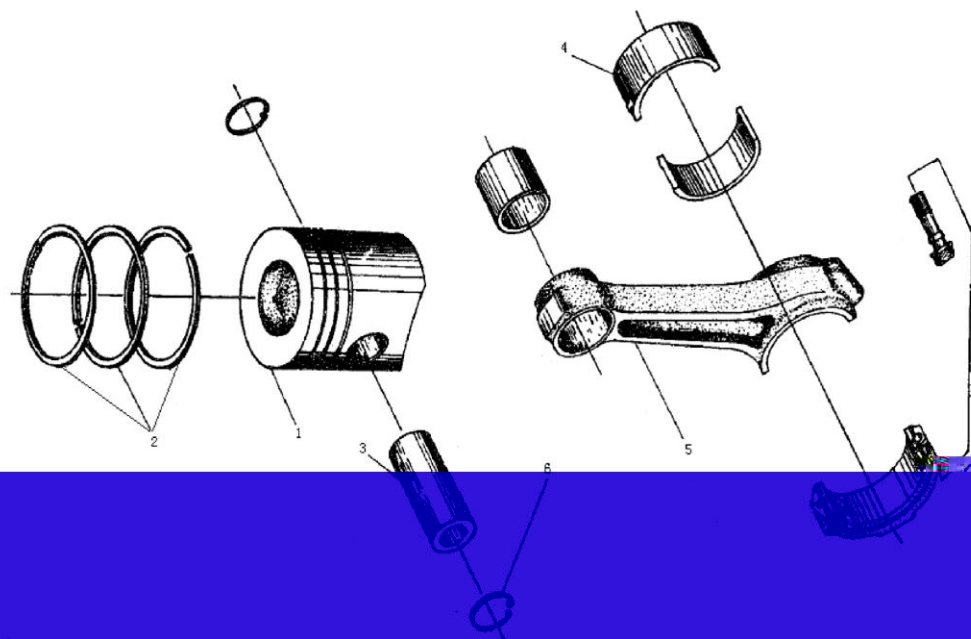

5. 活塞连杆总成

PISTON & CONNECTING ROD ASSEMBLY

柴油机型号 Model No.			4RMZG8	4RMC25-1	4RNSG3	4RNG3	4RMC20	4RMC20	4RMC20
供货号 Delivery No.					QZ2	NG1	QZ2	LZ2	
1	R1050001	活塞 Piston		4					6
	R1Z050001	活塞 Piston	4						
	R2Z050001	活塞 Piston					4		
	R5050000	活塞 Piston				4			
	R5050001-S	活塞 Piston			4				
2	R1050002	活塞环结合件 Piston ring	4	4					6
	R1050002-A-JH	活塞环结合件 Piston ring					4		
	R5050002-JH	活塞环结合件 Piston ring			4				
	R5050002-A-JH	活塞环结合件 Piston ring				4			
R1050001	活塞环	4	4	4	4	4		6	

4	R050005	连杆轴瓦 Connecting rod bearing	8	8					12
5	R050003	连杆部件 Connecting rod subassembly	4	4	4	4	4		6
6	36GB893.1	衬套 Cushion bush	8	8	8	8	8		12

齿轮系总成
GEAR SYSTEM ASSEMBLY

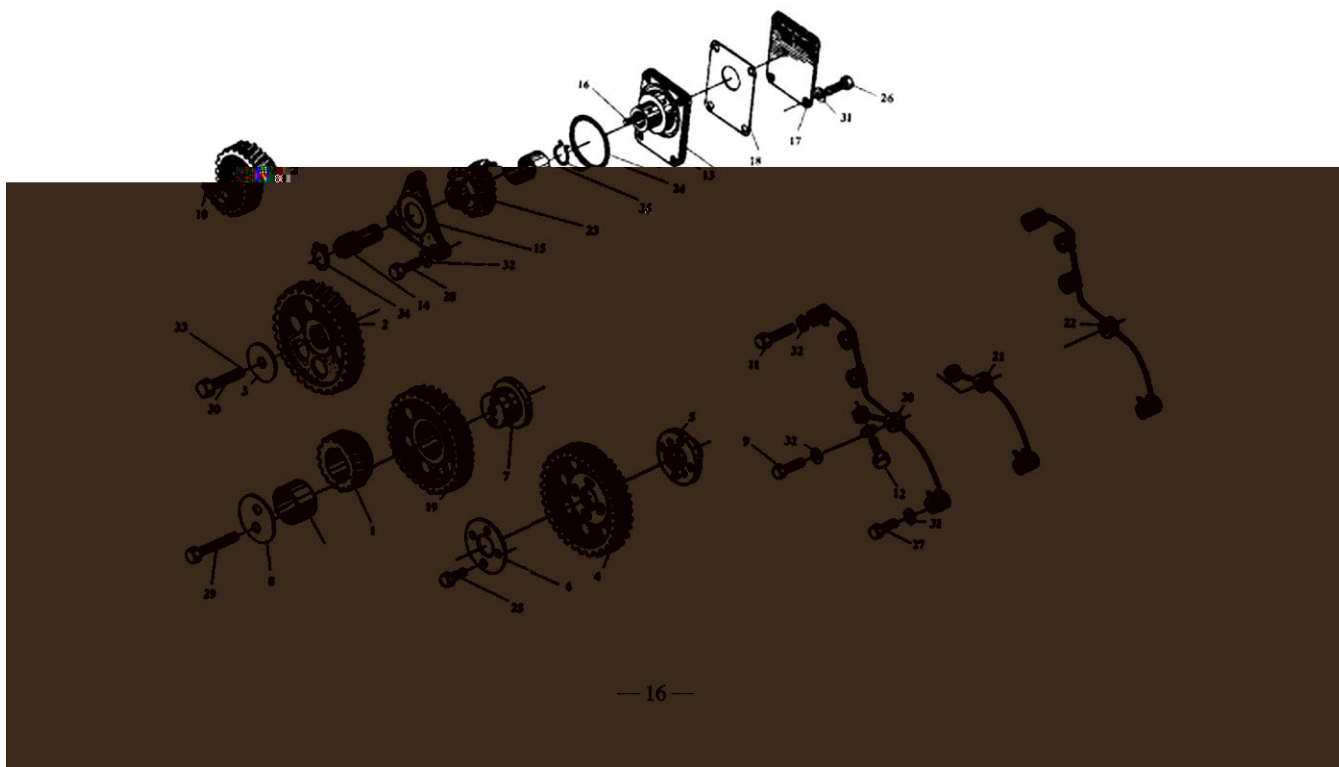

6. 齿轮系总成

GEAR SYSTEM ASSEMBLY

柴油机型号 Model				4RMZG8	4RMG25-1	4RNSG3	4RNG3	4RMAZG	6RMG20
供货号 Delivery No.						QZ2	XG1	QZ2	LZ2
1	R060001-A	曲轴齿轮	Crankshaft gear	1	1	1	1	1	1
2	R060002-A	喷油泵齿轮	Fuel injection pump gear						
3	R060003-A	惰齿轴	Idler gear shaft						
4	R060004-A	惰齿轴止推板	Thrust plate, idler gear						
5	R060006-1-C	喷油泵齿轮轮毂	Fuel injection pump gear hub						1
6	R060007-1	喷油泵齿轮压板	Plate, Fuel injection pump gear	1	1	1	1	1	1
7	R060009	惰齿轴	Idler gear shaft	1	1	1	1	1	1
8	R060011	惰齿轴止推板	Thrust plate, idler gear	1	1	1	1	1	1
9	R060012	正时齿轮润滑油道螺钉	banjo bolt, timing gear lubricating oil passage	1	1	1	1	1	1
10	RT060021-A	空压机齿轮	air compressor gear	1		1	1	1	1
11	RT060022	润滑油道螺钉	banjo bolt, lubricating oil pipe	1		1	1	1	1
12	RT060023	润滑油道螺钉	banjo bolt, lubricating oil pipe	1		1	1	1	1
13	RT060024	液压泵传动齿轮轴	driven gear shaft, hydraulic pump	1		1		1	1

柴油机型号 Model	4RMZG8	4RMG25-1	4RNSC3	4RNG3	4RMAZG	6RMG20
----------------	--------	----------	--------	-------	--------	--------

图号	零件名称	材料	4RMZG8	4RMG25-1	4RNSC3	4RNG3	4RMAZG	6RMG20
80	螺母	45	0	0	0	0	0	0
81	螺母	45	0	0	0	0	0	0
82	螺母	45	0	0	0	0	0	0
83	螺母	45	0	0	0	0	0	0
84	螺母	45	0	0	0	0	0	0
85	螺母	45	0	0	0	0	0	0
86	螺母	45	0	0	0	0	0	0
87	螺母	45	0	0	0	0	0	0
88	螺母	45	0	0	0	0	0	0
89	螺母	45	0	0	0	0	0	0
90	螺母	45	0	0	0	0	0	0
91	螺母	45	0	0	0	0	0	0
92	螺母	45	0	0	0	0	0	0
93	螺母	45	0	0	0	0	0	0
94	螺母	45	0	0	0	0	0	0
95	螺母	45	0	0	0	0	0	0
96	螺母	45	0	0	0	0	0	0
97	螺母	45	0	0	0	0	0	0
98	螺母	45	0	0	0	0	0	0
99	螺母	45	0	0	0	0	0	0
100	螺母	45	0	0	0	0	0	0

油底壳总成
OIL SUMP ASSEMBLY

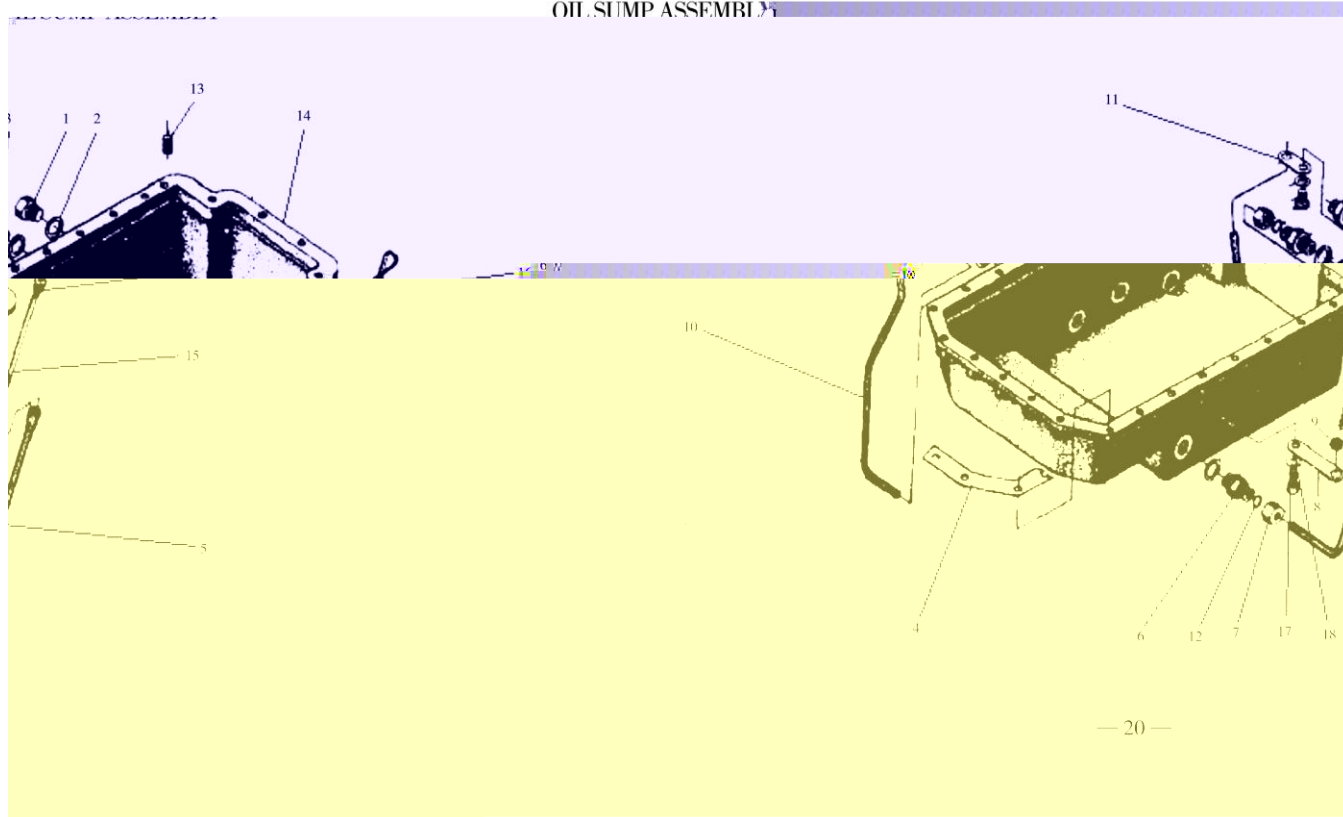

7. 油底壳总成
OIL SUMP ASSEMBLY

柴油机型号 Model				4RMZG8	4RMG25-1	4RNSG3	4RNG3	4RMAZG	6RMG20
供货号 Delivery No.						QZ2	XG1	QZ2	LZ2
1	R070001-A	放油螺塞	Oil drain plug	1	1		1		1
	R070001	放油螺塞	Oil drain plug	2	3	3	1	3	
2	R070002-1	螺塞垫圈	Washer,plug	4	4	4		4	4
3	R070003	温度表接头	Adapter,temperature gauge	1					1
4	4R070004	油底壳垫片	Gasket,oil sump	1		1	1	1	
	4RT070004	油底壳垫片	Gasket,oil sump		1				
	6R070004	油底壳垫片	Gasket,oil sump						1
5	R070008	油尺套管	Tube for dipstick	1	1	1	1	1	1
6	R070009	套管接头	Dipstick tube adapter	1	1	1	2	1	2
7	R070011	接头螺母	Nut,dipstick tube adapter	1	1	1	2	1	2
8	R070012	油尺套管支撑板	Support plate	1	1	1	1	1	1
9	R070013	橡胶圈	Rubber ring	1	1	1	1	1	2
10	R070014-1	分油器回油管	Oil drain pipe,oil separator						1
11	R070015	回油变容板	Support plate						1
12	R070021	复合胶圈	Composite rubber ring	1	1	1	1	1	2

柴油机型号 Model	4RMZG8	4RMG25-1	4RNSC3	4RNG3	4RMAZG	6RMC20
----------------	--------	----------	--------	-------	--------	--------

1	1	1	1	1	1	1
2	2	2	2	2	2	2
3	3	3	3	3	3	3
4	4	4	4	4	4	4
5	5	5	5	5	5	5
6	6	6	6	6	6	6
7	7	7	7	7	7	7
8	8	8	8	8	8	8
9	9	9	9	9	9	9
10	10	10	10	10	10	10
11	11	11	11	11	11	11
12	12	12	12	12	12	12
13	13	13	13	13	13	13
14	14	14	14	14	14	14
15	15	15	15	15	15	15
16	16	16	16	16	16	16
17	17	17	17	17	17	17
18	18	18	18	18	18	18
19	19	19	19	19	19	19
20	20	20	20	20	20	20
21	21	21	21	21	21	21
22	22	22	22	22	22	22
23	23	23	23	23	23	23
24	24	24	24	24	24	24
25	25	25	25	25	25	25
26	26	26	26	26	26	26
27	27	27	27	27	27	27
28	28	28	28	28	28	28
29	29	29	29	29	29	29
30	30	30	30	30	30	30
31	31	31	31	31	31	31
32	32	32	32	32	32	32
33	33	33	33	33	33	33
34	34	34	34	34	34	34
35	35	35	35	35	35	35
36	36	36	36	36	36	36
37	37	37	37	37	37	37
38	38	38	38	38	38	38
39	39	39	39	39	39	39
40	40	40	40	40	40	40
41	41	41	41	41	41	41
42	42	42	42	42	42	42
43	43	43	43	43	43	43
44	44	44	44	44	44	44
45	45	45	45	45	45	45
46	46	46	46	46	46	46
47	47	47	47	47	47	47
48	48	48	48	48	48	48
49	49	49	49	49	49	49
50	50	50	50	50	50	50
51	51	51	51	51	51	51
52	52	52	52	52	52	52
53	53	53	53	53	53	53
54	54	54	54	54	54	54
55	55	55	55	55	55	55
56	56	56	56	56	56	56
57	57	57	57	57	57	57
58	58	58	58	58	58	58
59	59	59	59	59	59	59
60	60	60	60	60	60	60
61	61	61	61	61	61	61
62	62	62	62	62	62	62
63	63	63	63	63	63	63
64	64	64	64	64	64	64
65	65	65	65	65	65	65
66	66	66	66	66	66	66
67	67	67	67	67	67	67
68	68	68	68	68	68	68
69	69	69	69	69	69	69
70	70	70	70	70	70	70
71	71	71	71	71	71	71
72	72	72	72	72	72	72
73	73	73	73	73	73	73
74	74	74	74	74	74	74
75	75	75	75	75	75	75
76	76	76	76	76	76	76
77	77	77	77	77	77	77
78	78	78	78	78	78	78
79	79	79	79	79	79	79
80	80	80	80	80	80	80
81	81	81	81	81	81	81
82	82	82	82	82	82	82
83	83	83	83	83	83	83
84	84	84	84	84	84	84
85	85	85	85	85	85	85
86	86	86	86	86	86	86
87	87	87	87	87	87	87
88	88	88	88	88	88	88
89	89	89	89	89	89	89
90	90	90	90	90	90	90
91	91	91	91	91	91	91
92	92	92	92	92	92	92
93	93	93	93	93	93	93
94	94	94	94	94	94	94
95	95	95	95	95	95	95
96	96	96	96	96	96	96
97	97	97	97	97	97	97
98	98	98	98	98	98	98
99	99	99	99	99	99	99
100	100	100	100	100	100	100

正时齿轮室总成
TIMING GEAR CASE ASSEMBLY

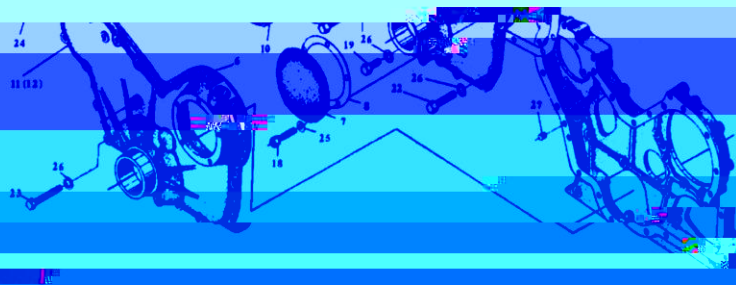
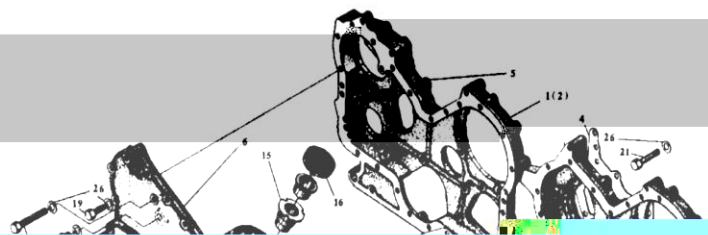

8. 正时齿轮室总成

TIMING GEAR CASE ASSEMBLY

柴油机型号 Model				4RMZG8	4RMG25-1	4RNSG3	4RNG3	4RMAZG	6RMG20
供货号 Delivery No.						QZ2	XG1	QZ2	LZ2
1	4RC4080001	正时齿轮室	Timing gear case	1		1		1	
2	6R1T080001-1	正时齿轮室	Timing gear case		1				
3	6RQ080001	正时齿轮室	Timing gear case				1		1
4	R080002	齿轮室垫片	Gasket gear case				1		1
5	RT080002	齿轮室垫片	Gasket gear case						

后油封壳体总成
REAR OIL SEAL HOUSING ASSEMBLY

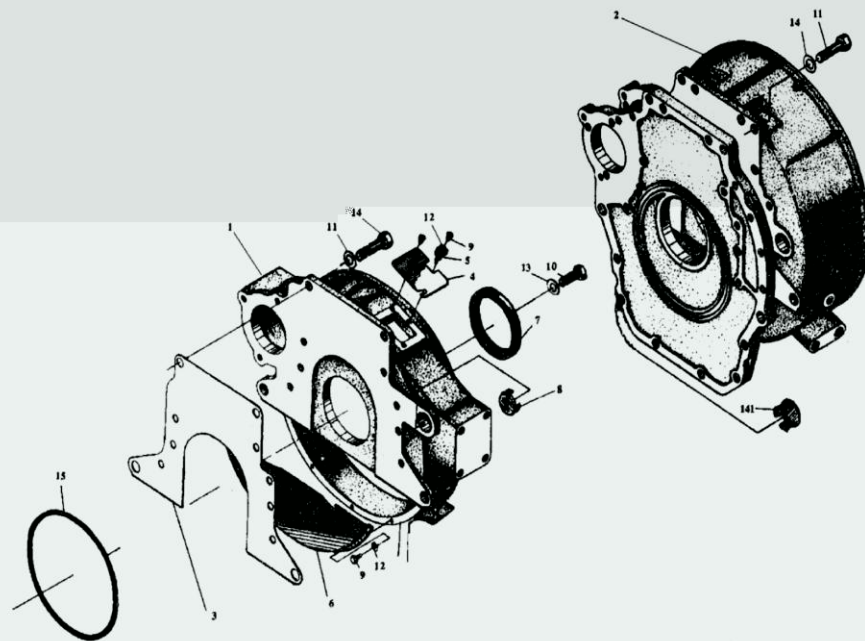

9. 后油封壳体总成
REAR OIL SEAL HOUSING ASSEMBLY

柴油机型号 Model				4RMZG8	4RMG25-1	4RNSG3	4RNG3	4RMAZG	6RMG20
供货号 Delivery No.						QZ2	XG1	QZ2	LZ2
1	R090001	飞轮壳	Flywheel housing	1		1	1	1	1
2	4R1G25090001	飞轮壳	Flywheel housing		1				
3	R090002	飞轮壳垫片	Gasket,flywheel housing	1		1	1	1	1
4	R090003-1	检视窗盖	Cover,inspection window	1	1	1	1	1	1
5	R090004	喇叭	horn	1	1	1	1	1	1
6	R090005-A	盖板	dust Cover	1		1	1	1	1
7	R090006-A	曲轴后油封	Rear oil seal, crankshaft	1	1	1	1	1	1
8	R090007-1	堵塞	Plug	1	1	1	1	1	1

曲轴箱通风装置总成
CRANKCASE VENTILATION ASSEMBLY

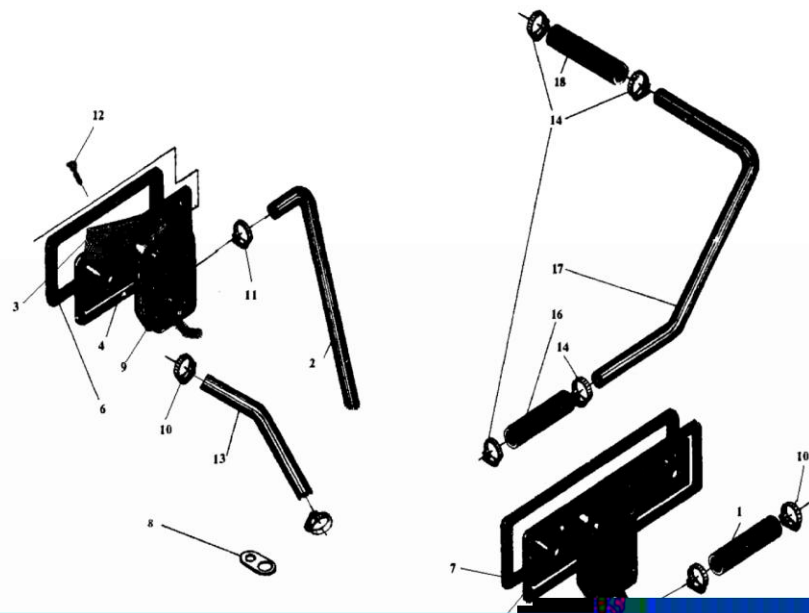

10. 曲轴箱通风装置总成

CRAFTER DIESEL VENTILATION ASSEMBLY

柴 油 机 型 号 Model				4RMZG8	4RMG25-1	4RNSG3	4RNG3	4RMAZG	6RMG20
供货号 Delivery No.						QZ2	XG1	QZ2	LZ2
1	6R120001-A	接头胶管	Connecting hose						1
2	4R1T120011	出气胶管	Oil gas rubber hose	1	1	1	1	1	
3	R120007-A	后推杆室隔板	Rear pushrod chamber baffle plate	1	1	1	1	1	1
4	4R120008	后推杆室盖	Rear pushrod chamber cover	1	1	1	1	1	
5	6R120008	后推杆室盖	Rear pushrod chamber cover						1
6	495-01024(b)	侧盖板垫片	Gasket,upper side cover	1	1	1	1	1	
7	6R020009	推杆室盖垫片	Pushrod chamber gasket						1
8	6R1Q3120021	管卡	Pipe clamp						1
9	R120100	通风装置焊合件	Ventilation device subassembly	1	1	1	1	1	1
10	R120400	胶管夹箍部件	Hose clamp subassembly	1	1	1	1	1	2
11	φ22-32Q67532	胶管夹箍	Hose clamp	1	1	1	1	1	1
12	M6 × 8GB818	十字花盘头螺钉	Screw	2	2	2	2	2	2
13	4R120001-1	分油器回油管	oil return pipe,breather	1	1	1	1	1	
14	Φ30 钢丝卡箍	Φ30 钢丝卡箍	Φ30 hose clamp	1	1	1	1	1	4
15	4R1ZT2730501	回油接头	oil return joint		1	1			

柴油機

1. 柴油機的主要組成部分

1. 柴油機的主要組成部分

2. 柴油機的主要組成部分

3. 柴油機的主要組成部分

4. 柴油機的主要組成部分

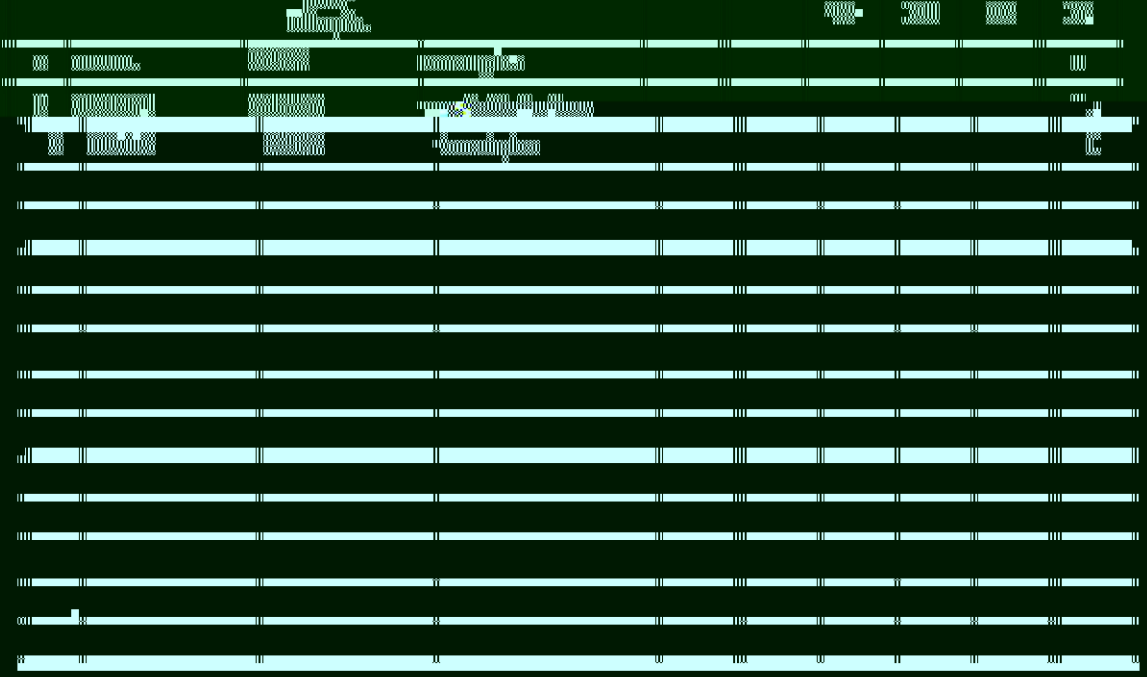

柴油機的主要組成部分

空滤器总成
AIR CLEANER ASSEMBLY

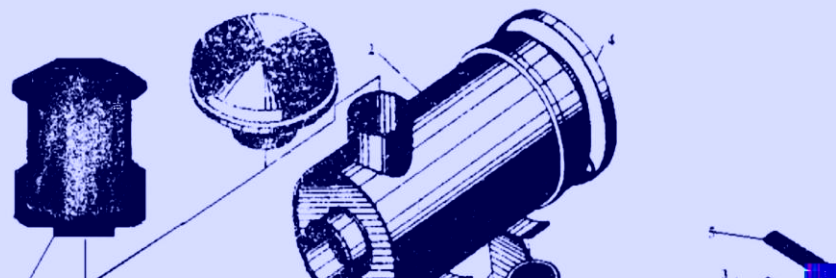

11. 空滤器总成
AIR CLEANER ASSEMBLY

柴油机型号 Model				4RMZG8	4RMG25-1	4RNSG3	4RNG3	4RMAZG	6RMG20
供货号 Delivery No.						QZ2	XG1	QZ2	LZ2
1	ZH4100G1-8B-07110	空气预滤器	Air cleaner subassembly			1			
	4R1C78210200	空气预滤器	Air cleaner subassembly				1	1	
2	4R1ZD1210100	空气滤清器部件	Air cleaner subassembly	1					
	ZH4100G-07120-A	空气滤清器部件	Air cleaner subassembly			1			
	4RNG3210100-1	空气滤清器部件	Air cleaner subassembly				1		
	4R1C78210100-1	空气滤清器部件	Air cleaner subassembly					1	
	6R1G6210100	空气滤清器部件	Air cleaner subassembly						1
	4RZ210400	空滤器支架焊合件	Air cleaner support welding part	1					
3	4R4ZLD210400	空滤支架焊合件	Air cleaner support welding part			1			
	4R1C74210600	空滤支架焊合件	Air cleaner support welding part				1	1	
	6R1C20210600	空滤支架焊合件	Air cleaner support welding part						1
	ZH4100K42-07200	空滤卡箍部件	Air cleaner clamp subassembly			1			
4	4R1C74210200	空滤卡箍部件	Air cleaner clamp subassembly				2	1	
	6R1Z210500	空滤卡箍部件	Air cleaner clamp subassembly						2
	6R1Q210500	空滤卡箍部件	Air cleaner clamp subassembly	1					

柴油机型号 Model	4RMZG8	4RMG25-1	4RNSG3	4RNG3	4RMAZG	6RMG20
----------------	--------	----------	--------	-------	--------	--------

零件号	零件名称	规格	4RMZG8	4RMG25-1	4RNSG3	4RNG3	4RMAZG	6RMG20
1000000000	柴油发动机	4RMZG8	1					
1000000000	柴油发动机	4RMG25-1		1				
1000000000	柴油发动机	4RNSG3			1			
1000000000	柴油发动机	4RNG3				1		
1000000000	柴油发动机	4RMAZG					1	
1000000000	柴油发动机	6RMG20						1
1000000000	柴油发动机	4RMZG8	1					
1000000000	柴油发动机	4RMG25-1		1				
1000000000	柴油发动机	4RNSG3			1			
1000000000	柴油发动机	4RNG3				1		
1000000000	柴油发动机	4RMAZG					1	
1000000000	柴油发动机	6RMG20						1
1000000000	柴油发动机	4RMZG8	1					
1000000000	柴油发动机	4RMG25-1		1				
1000000000	柴油发动机	4RNSG3			1			
1000000000	柴油发动机	4RNG3				1		
1000000000	柴油发动机	4RMAZG					1	
1000000000	柴油发动机	6RMG20						1

进气管总成
AIR INLET MANIFOLD ASSEMBLY

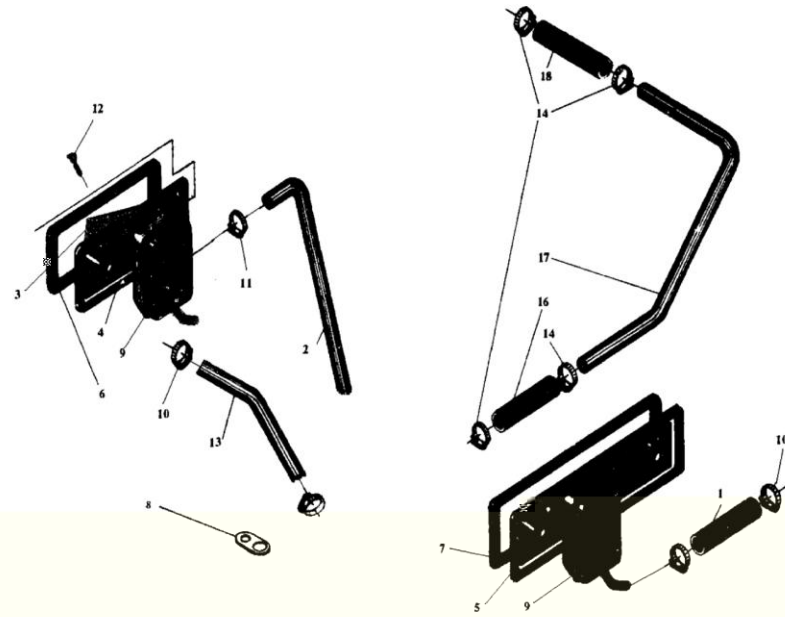

12. 进气管总成

AIR INLET MANIFOLD ASSEMBLY

		柴 油 机 型 号		4RMZG8	4RMG25-1	4RNSG3	4RNG3	4RMAZG	6RMC20
		Model							
		供 货 号				QZ2	XG1	QZ2	LZ2
		Delivery No.							
1	4R1T220001-A	进气管	Inlet manifold		1				
	4R4ZT3220001	进气管	Inlet manifold			1			
2	4R220001-1-A	进气管	Inlet manifold	1					
3	4R1G52220001	进气管	Inlet manifold				1		
4	6R220001	进气管	Inlet manifold						1
5	4R220002-1	进气接管垫片	Gasket,air inlet connecting pipe	3	3	4	3		
6	6R220002	进气接管垫片	Gasket,air inlet connecting pipe						4
7	R220003	进气歧管垫片	Inlet manifold gasket	4	4		4	4	6
	R5220003	进气歧管垫片	Inlet manifold gasket			4			
8	4R220005-A	进气管盖板	Cover,inlet manifold	2	2	1	2	2	
9	6R220005	进气管盖板	Cover,inlet manifold						3
10	4R220200-1	进气管盖板部件	inlet manifold Cover subassembly			1			
11	4RZD220021	进气联接管	Air inlet connecting pipe						

柴油 机 型 号		4RMZG8	4RMG25-1	4RNSC3	4RNG3	4RMAZG	6RMC20
Model							
01	1000000000	0000		0000	0000	0000	0000
02	1000000000	0000		0000	0000	0000	0000
03	1000000000	0000		0000	0000	0000	0000
04	1000000000	0000		0000	0000	0000	0000
05	1000000000	0000		0000	0000	0000	0000
06	1000000000	0000		0000	0000	0000	0000
07	1000000000	0000		0000	0000	0000	0000
08	1000000000	0000		0000	0000	0000	0000
09	1000000000	0000		0000	0000	0000	0000
10	1000000000	0000		0000	0000	0000	0000
11	1000000000	0000		0000	0000	0000	0000
12	1000000000	0000		0000	0000	0000	0000
13	1000000000	0000		0000	0000	0000	0000
14	1000000000	0000		0000	0000	0000	0000
15	1000000000	0000		0000	0000	0000	0000
16	1000000000	0000		0000	0000	0000	0000
17	1000000000	0000		0000	0000	0000	0000
18	1000000000	0000		0000	0000	0000	0000
19	1000000000	0000		0000	0000	0000	0000
20	1000000000	0000		0000	0000	0000	0000
21	1000000000	0000		0000	0000	0000	0000
22	1000000000	0000		0000	0000	0000	0000
23	1000000000	0000		0000	0000	0000	0000
24	1000000000	0000		0000	0000	0000	0000
25	1000000000	0000		0000	0000	0000	0000
26	1000000000	0000		0000	0000	0000	0000
27	1000000000	0000		0000	0000	0000	0000
28	1000000000	0000		0000	0000	0000	0000
29	1000000000	0000		0000	0000	0000	0000
30	1000000000	0000		0000	0000	0000	0000
31	1000000000	0000		0000	0000	0000	0000
32	1000000000	0000		0000	0000	0000	0000
33	1000000000	0000		0000	0000	0000	0000
34	1000000000	0000		0000	0000	0000	0000
35	1000000000	0000		0000	0000	0000	0000
36	1000000000	0000		0000	0000	0000	0000
37	1000000000	0000		0000	0000	0000	0000
38	1000000000	0000		0000	0000	0000	0000
39	1000000000	0000		0000	0000	0000	0000
40	1000000000	0000		0000	0000	0000	0000
41	1000000000	0000		0000	0000	0000	0000
42	1000000000	0000		0000	0000	0000	0000
43	1000000000	0000		0000	0000	0000	0000
44	1000000000	0000		0000	0000	0000	0000
45	1000000000	0000		0000	0000	0000	0000
46	1000000000	0000		0000	0000	0000	0000
47	1000000000	0000		0000	0000	0000	0000
48	1000000000	0000		0000	0000	0000	0000
49	1000000000	0000		0000	0000	0000	0000
50	1000000000	0000		0000	0000	0000	0000

排气系统总成
EXHAUST SYSTEM ASSEMBLY

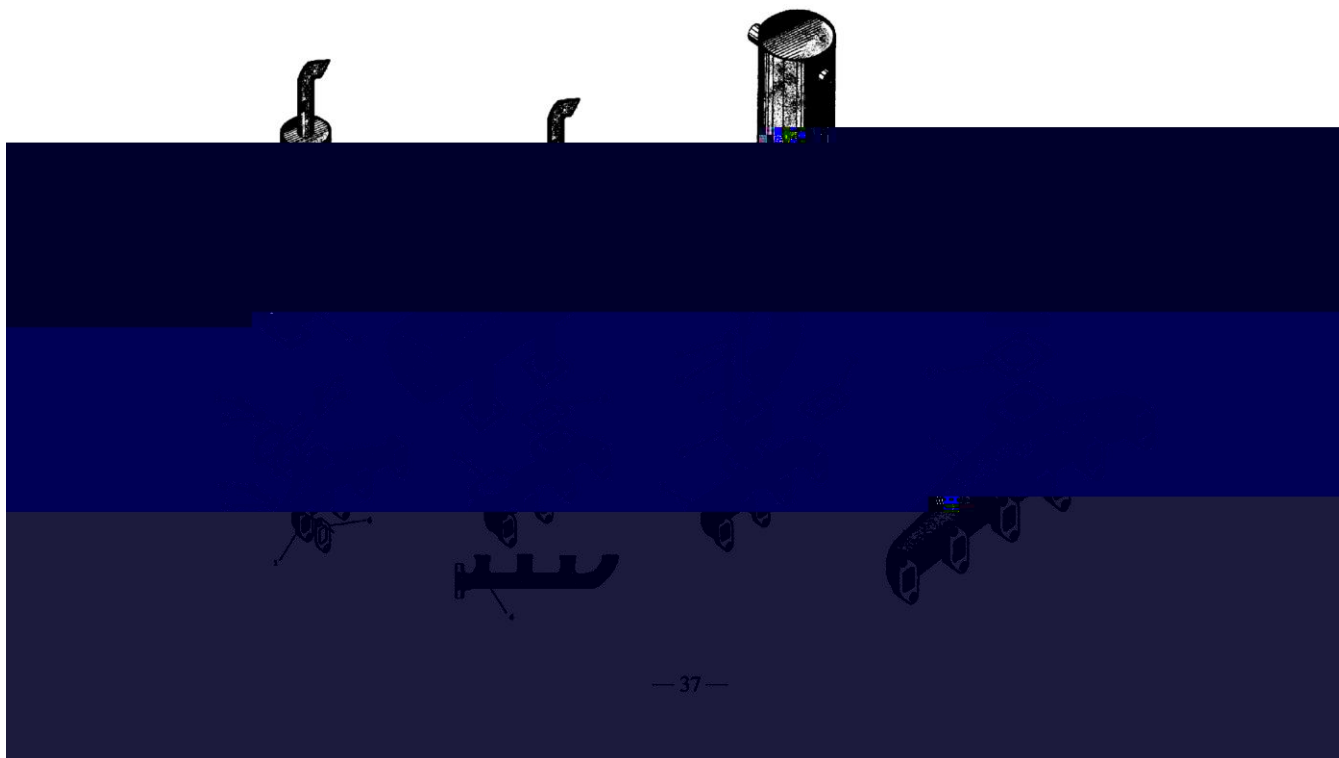

13. 排气系统总成

EXHAUST SYSTEM ASSEMBLY

柴油机型号 Model		4RMZG8	4RMG25-1	4RNSG3	4RNG3	4RMAZG	6RMG20
供货号 Delivery No.				QZ2	XG1	QZ2	LZ2
1	4R230001	排气管	Exhaust manifold		1		
2	4RZD230001	排气管	Exhaust manifold	1			
3	4R5L230001	排气管	Exhaust manifold			1	
4	4R4ZG230001-A	排气管	Exhaust manifold			1	
5	6R1G5230001-1	排气管	Exhaust manifold				1
6	R230002	排气歧管垫片	Exhaust manifold gasket	4	4	4	4
7	4R230003	排气接管垫片	Gasket,exhaust connecting pipe		1	2	
8	4R1T19-1230003	排气接管垫片	Gasket,exhaust connecting pipe			2	
9	6R1G10230003	排气接管垫片	Gasket,exhaust connecting pipe				1
10	4RZD730001	增压器垫片	Turbocharger gasket	2			
11	4RZD230104	排气弯管	Exhaust elbow	1			
11	4R1ZT2080101-1	正时齿轮室盖	Cover,timing gear case		1		
12	6RQ080101	正时齿轮室盖	Cover,timing gear case			1	1
13	RT060028	盖板	Cover, hydraulic pump	1	1	1	

柴油机型号 Model	4RMZC8	4RMG25-1	4RNSG3	4RNG3	4RMAZC	6RMG20
----------------	--------	----------	--------	-------	--------	--------

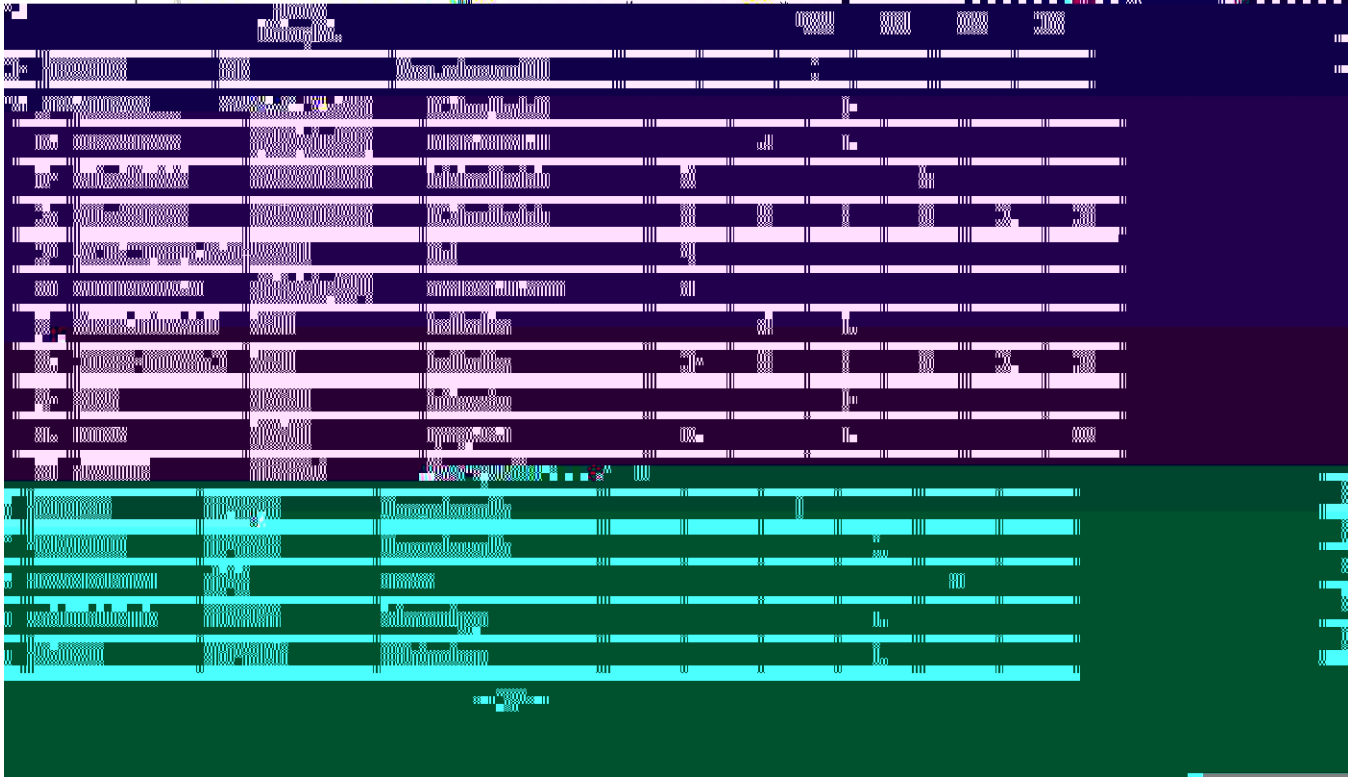

燃油系统总成
FUEL SYSTEM ASSEMBLY

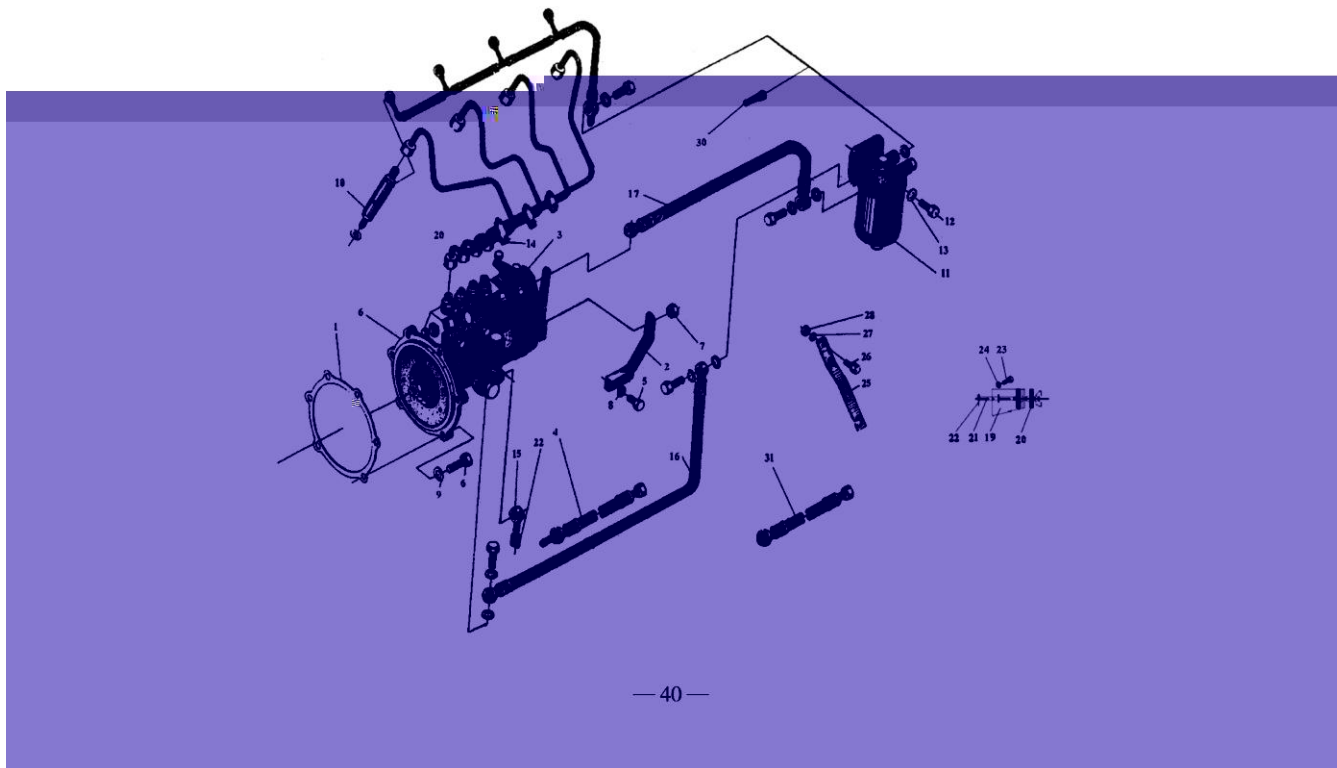

14. 燃油系统总成
FUELSYSTEMASSEMBLY

柴 油 机 型 号 Model				4RMZG8	4RMG25-1	4RNSG3	4RNG3	4RMAZG	6RMG20
供货号 Delivery No.						QZ2	XG1	QZ2	LZ2
1	R310001	喷油泵垫片	Gasket,fuel injection pump	1	1	1	1	1	1
2	4R310002-A	喷油泵辅助支架	Auxiliary bracket for fuel injection pump	1	1	1	1	1	
3	4R1C78310100	喷油泵部件	Fuel injection pump subassembly				1		
	4RZ310100-A	喷油泵部件	Fuel injection pump subassembly	1					
	4RC310100-A	喷油泵部件	Fuel injection pump subassembly		1				
	4RC310100-C	喷油泵部件	Fuel injection pump subassembly			1		1	
	6R1C20310100-A	喷油泵部件	Fuel injection pump subassembly						1
4	4R1ZT2310200	喷油泵润滑油管部件	Lubricating pipe subassembly,fuel injection pump	1	1	1	1	1	1
5	M8×20GB5783	全螺纹六角头螺栓	Full thread hex bolt	2	2	2	2	2	2
6	M10×30GB5783	全螺纹六角头螺栓	Full thread hex bolt	4	4	4	4	4	4
7	M10GB6170-Zn.D	六角螺母	Hex nut	1	1	1	1	1	1
8	8GB848-140HV-Zn.D	小垫圈	Small washer	2	2	2	2	2	2
9	10GB848-140HV-Zn.D	小垫圈	Small washer	4	4	4	4	4	4
10	4R5T1320100	喷油器部件	Injector subassembly	4	4	4	4	4	4

柴油机型号 Model	4RMZG8	4RMG25-1	4RNSG3	4RNG3	4RMAZG	6RMG20
----------------	--------	----------	--------	-------	--------	--------

1	1	1	1	1	1	1
2	2	2	2	2	2	2
3	3	3	3	3	3	3
4	4	4	4	4	4	4
5	5	5	5	5	5	5
6	6	6	6	6	6	6
7	7	7	7	7	7	7
8	8	8	8	8	8	8
9	9	9	9	9	9	9
10	10	10	10	10	10	10
11	11	11	11	11	11	11
12	12	12	12	12	12	12
13	13	13	13	13	13	13
14	14	14	14	14	14	14
15	15	15	15	15	15	15
16	16	16	16	16	16	16
17	17	17	17	17	17	17
18	18	18	18	18	18	18
19	19	19	19	19	19	19
20	20	20	20	20	20	20
21	21	21	21	21	21	21
22	22	22	22	22	22	22
23	23	23	23	23	23	23
24	24	24	24	24	24	24
25	25	25	25	25	25	25
26	26	26	26	26	26	26
27	27	27	27	27	27	27
28	28	28	28	28	28	28
29	29	29	29	29	29	29
30	30	30	30	30	30	30
31	31	31	31	31	31	31
32	32	32	32	32	32	32
33	33	33	33	33	33	33
34	34	34	34	34	34	34
35	35	35	35	35	35	35
36	36	36	36	36	36	36
37	37	37	37	37	37	37
38	38	38	38	38	38	38
39	39	39	39	39	39	39
40	40	40	40	40	40	40
41	41	41	41	41	41	41
42	42	42	42	42	42	42
43	43	43	43	43	43	43
44	44	44	44	44	44	44
45	45	45	45	45	45	45
46	46	46	46	46	46	46
47	47	47	47	47	47	47
48	48	48	48	48	48	48
49	49	49	49	49	49	49
50	50	50	50	50	50	50
51	51	51	51	51	51	51
52	52	52	52	52	52	52
53	53	53	53	53	53	53
54	54	54	54	54	54	54
55	55	55	55	55	55	55
56	56	56	56	56	56	56
57	57	57	57	57	57	57
58	58	58	58	58	58	58
59	59	59	59	59	59	59
60	60	60	60	60	60	60
61	61	61	61	61	61	61
62	62	62	62	62	62	62
63	63	63	63	63	63	63
64	64	64	64	64	64	64
65	65	65	65	65	65	65
66	66	66	66	66	66	66
67	67	67	67	67	67	67
68	68	68	68	68	68	68
69	69	69	69	69	69	69
70	70	70	70	70	70	70
71	71	71	71	71	71	71
72	72	72	72	72	72	72
73	73	73	73	73	73	73
74	74	74	74	74	74	74
75	75	75	75	75	75	75
76	76	76	76	76	76	76
77	77	77	77	77	77	77
78	78	78	78	78	78	78
79	79	79	79	79	79	79
80	80	80	80	80	80	80
81	81	81	81	81	81	81
82	82	82	82	82	82	82
83	83	83	83	83	83	83
84	84	84	84	84	84	84
85	85	85	85	85	85	85
86	86	86	86	86	86	86
87	87	87	87	87	87	87
88	88	88	88	88	88	88
89	89	89	89	89	89	89
90	90	90	90	90	90	90
91	91	91	91	91	91	91
92	92	92	92	92	92	92
93	93	93	93	93	93	93
94	94	94	94	94	94	94
95	95	95	95	95	95	95
96	96	96	96	96	96	96
97	97	97	97	97	97	97
98	98	98	98	98	98	98
99	99	99	99	99	99	99
100	100	100	100	100	100	100

柴油机型号 Model	4RMZG8	4RMG25-1	4RNSG3	4RNG3	4RMAZG	6RMG20
----------------	--------	----------	--------	-------	--------	--------

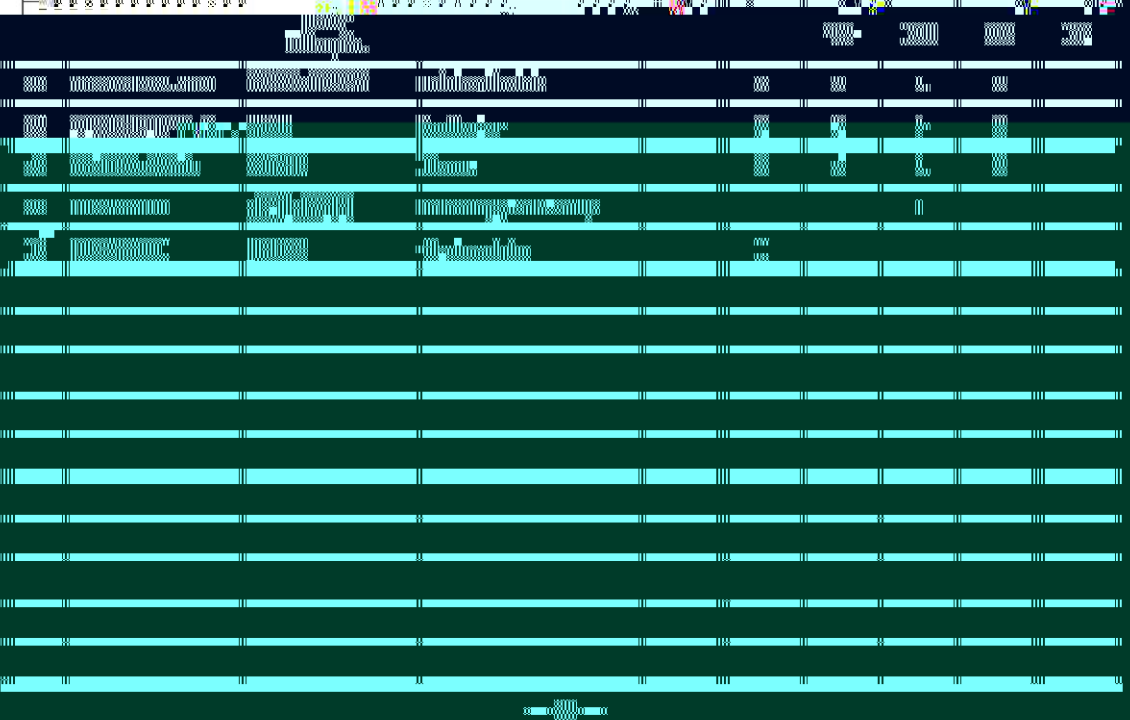

润滑系统总成
LUBRICATING SYSTEM ASSEMBLY

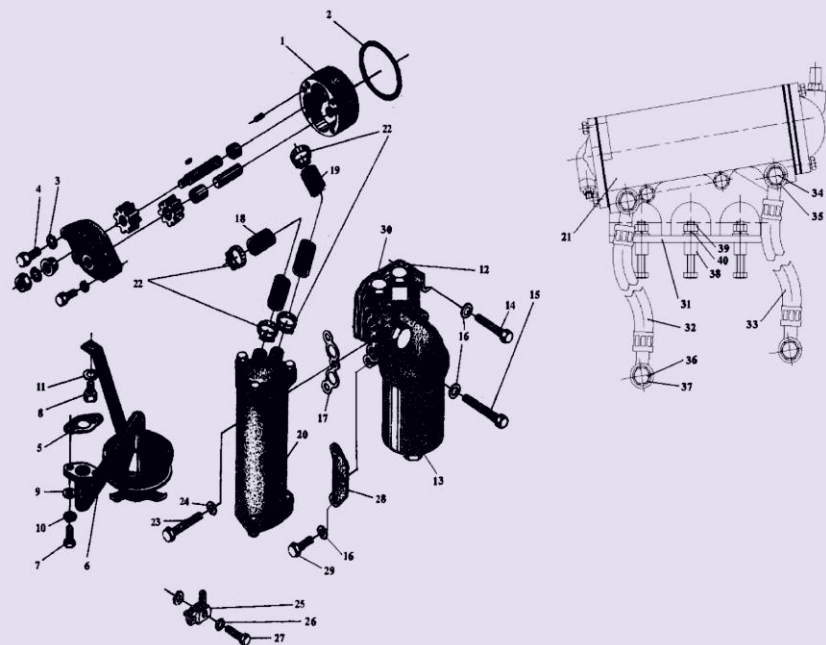

15. 润滑系统总成
LUBRICATING SYSTEM ASSEMBLY

柴油机型号 Model				4RMZG8	4RMG25-1	4RNSG3	4RNG3	4RMAZG	6RMG20
供货号 Delivery No.						QZ2	XG1	QZ2	LZ2
1	4R410100-2	机油泵	Oil pump		1		1		
	6R410100-2	机油泵	Oil pump	1		1		1	1
2	100 × 3.1GB1235-76	O 型橡胶密封圈	"O" type rubber seal ring	2	2	2	2	2	2
3	M10 × 30GB5783	全螺纹六角头螺栓	Full thread hex bolt	2	2	2	2	2	2

冷却系统总成
COOLING SYSTEM ASSEMBLY

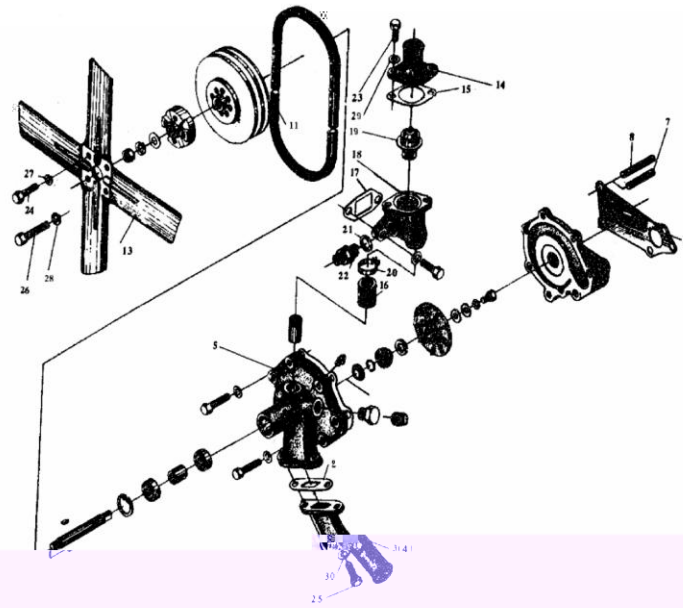

16. 冷却系统总成
COOLING SYSTEM ASSEMBLY

柴油机型号 Model				4RMZG8	4RMG25-1	4RNSG3	4RNG3	4RMAZG	6RMG20
供货号 Delivery No.						QZ2	XG1	QZ2	LZ2
1	R510007	垫片	Gasket	1	1	1	1	1	1
2	R510009	垫片	Gasket	1	1	1	1	1	1
3	R510011	接管	Connecting pipe		1	1	1	1	1
4	6R1P510011	水泵接管	Water pump connecting pipe						

5	R510100	水泵部件	Water pump subassembly			1			
	6R0510100	水泵部件	Water pump subassembly					1	
	0R111510100	水泵部件	Water pump subassembly	1					

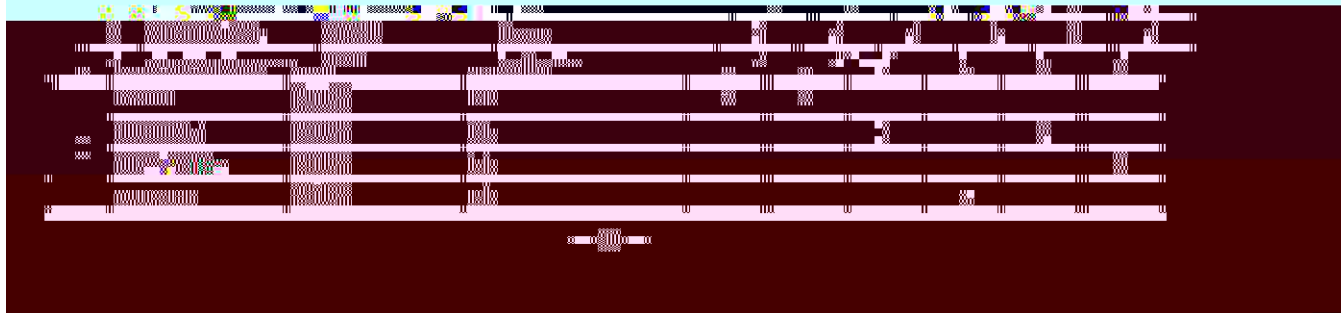

柴油 机 型 号 Model			4RMZG8	4RMC25-1	4RNSG3	4RNG3	4RMAZG	6RMC20
1	1	1	1	1	1	1	1	1
2	2	2	2	2	2	2	2	2
3	3	3	3	3	3	3	3	3
4	4	4	4	4	4	4	4	4
5	5	5	5	5	5	5	5	5
6	6	6	6	6	6	6	6	6
7	7	7	7	7	7	7	7	7
8	8	8	8	8	8	8	8	8
9	9	9	9	9	9	9	9	9
10	10	10	10	10	10	10	10	10
11	11	11	11	11	11	11	11	11
12	12	12	12	12	12	12	12	12
13	13	13	13	13	13	13	13	13
14	14	14	14	14	14	14	14	14
15	15	15	15	15	15	15	15	15
16	16	16	16	16	16	16	16	16
17	17	17	17	17	17	17	17	17
18	18	18	18	18	18	18	18	18
19	19	19	19	19	19	19	19	19
20	20	20	20	20	20	20	20	20
21	21	21	21	21	21	21	21	21
22	22	22	22	22	22	22	22	22
23	23	23	23	23	23	23	23	23
24	24	24	24	24	24	24	24	24
25	25	25	25	25	25	25	25	25
26	26	26	26	26	26	26	26	26
27	27	27	27	27	27	27	27	27
28	28	28	28	28	28	28	28	28
29	29	29	29	29	29	29	29	29
30	30	30	30	30	30	30	30	30
31	31	31	31	31	31	31	31	31
32	32	32	32	32	32	32	32	32
33	33	33	33	33	33	33	33	33
34	34	34	34	34	34	34	34	34
35	35	35	35	35	35	35	35	35
36	36	36	36	36	36	36	36	36
37	37	37	37	37	37	37	37	37
38	38	38	38	38	38	38	38	38
39	39	39	39	39	39	39	39	39
40	40	40	40	40	40	40	40	40
41	41	41	41	41	41	41	41	41
42	42	42	42	42	42	42	42	42
43	43	43	43	43	43	43	43	43
44	44	44	44	44	44	44	44	44
45	45	45	45	45	45	45	45	45
46	46	46	46	46	46	46	46	46
47	47	47	47	47	47	47	47	47
48	48	48	48	48	48	48	48	48
49	49	49	49	49	49	49	49	49
50	50	50	50	50	50	50	50	50
51	51	51	51	51	51	51	51	51
52	52	52	52	52	52	52	52	52
53	53	53	53	53	53	53	53	53
54	54	54	54	54	54	54	54	54
55	55	55	55	55	55	55	55	55
56	56	56	56	56	56	56	56	56
57	57	57	57	57	57	57	57	57
58	58	58	58	58	58	58	58	58
59	59	59	59	59	59	59	59	59
60	60	60	60	60	60	60	60	60
61	61	61	61	61	61	61	61	61
62	62	62	62	62	62	62	62	62
63	63	63	63	63	63	63	63	63
64	64	64	64	64	64	64	64	64
65	65	65	65	65	65	65	65	65
66	66	66	66	66	66	66	66	66
67	67	67	67	67	67	67	67	67
68	68	68	68	68	68	68	68	68
69	69	69	69	69	69	69	69	69
70	70	70	70	70	70	70	70	70
71	71	71	71	71	71	71	71	71
72	72	72	72	72	72	72	72	72
73	73	73	73	73	73	73	73	73
74	74	74	74	74	74	74	74	74
75	75	75	75	75	75	75	75	75
76	76	76	76	76	76	76	76	76
77	77	77	77	77	77	77	77	77
78	78	78	78	78	78	78	78	78
79	79	79	79	79	79	79	79	79
80	80	80	80	80	80	80	80	80
81	81	81	81	81	81	81	81	81
82	82	82	82	82	82	82	82	82
83	83	83	83	83	83	83	83	83
84	84	84	84	84	84	84	84	84
85	85	85	85	85	85	85	85	85
86	86	86	86	86	86	86	86	86
87	87	87	87	87	87	87	87	87
88	88	88	88	88	88	88	88	88
89	89	89	89	89	89	89	89	89
90	90	90	90	90	90	90	90	90
91	91	91	91	91	91	91	91	91
92	92	92	92	92	92	92	92	92
93	93	93	93	93	93	93	93	93
94	94	94	94	94	94	94	94	94
95	95	95	95	95	95	95	95	95
96	96	96	96	96	96	96	96	96
97	97	97	97	97	97	97	97	97
98	98	98	98	98	98	98	98	98
99	99	99	99	99	99	99	99	99
100	100	100	100	100	100	100	100	100

电器系统总成
ELECTRICAL SYSTEM ASSEMBLY



17. 电器系统总成
ELECTRICAL SYSTEM ASSEMBLY

柴油机型号				4RMZG8	4RMG25-1	4RNSG3	4RNG3	4RMAZG	6RMG20
Model									
供货号						QZ2	XG1	QZ2	LZ2
Delivery No.									
1	4RC610100-A	起动机部件	Starter motor subassembly	1	1	1	1	1	1
2	M10 × 30GB5783	全螺纹六角头螺栓	Full thread hex bolt	3	3	3	3	3	3
3	10GB848-140HV-Zn.D	小垫圈	Small washer	3	3	3	3	3	3
	6R620100	发电机部件	Charging alternator subassembly	1		1		1	
5	4R1620001-B	发电机调节架	Alternator adjusting bracket		1				
	6R1C5-1620001-1	发电机调节架	Alternator adjusting bracket				1		1
6	M8 × 25GB5783	全螺纹六角头螺栓	Full thread hex bolt	1	1	1	1	1	1
7	4B620005	发电机螺栓	Alternator bolt	1		1		1	1

空气压缩机总成
AIR COMPRESSOR ASSEMBLY

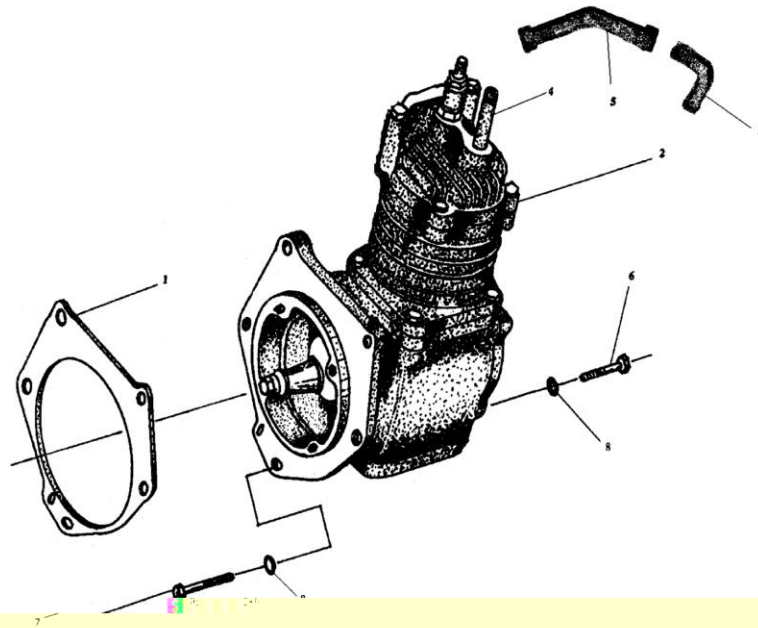

18. 空气压缩机总成

AIR COMPRESSOR ASSEMBLY

柴油机型号 Model				4RMZG8	4RMG25-1	4RNSG3	4RNG3	4RMAZG	6RMG20
供货号 Delivery No.						QZ2	XG1	QZ2	LZ2
1	4R1G34710100	空气压缩机部件	air compressor subassembly			1			
	4R1G74710100	空压机部件	air compressor subassembly				1		
	4RT710001	空压机垫片	Gasket,air compressor			1	1	1	1
2	4R2ZG710100	空气压缩机部件	air compressor subassembly					1	
	6R1G5710100	空气压缩机部件	air compressor subassembly						1
	3	6R1G10220021	进气管接头	joint, Inlet manifold		1	1		1
4	6R1G10710021	空压机进气接头	Joint,air compressor inlet port			1	1		1

增压器总成
TURBOCHARGER ASSEMBLY

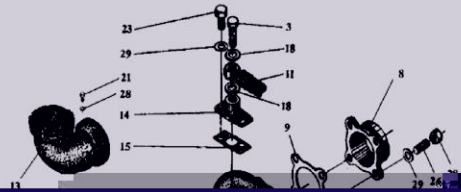

19. 增压器总成
TURBOCHARGER ASSEMBLY

柴油机型号 Model				4RMZG8	4RMG25-1	4RNSG3	4RNG3	4RMAZG	6RMG20
供货号 Delivery No.						QZ2	XG1	QZ2	LZ2
1	4R1ZT3730001	增压器垫片	Turbocharger gasket			1			
2	4RZ730002	机滤器支架	Bracket,oil filter	1		1			
3	495Z-23004	接头螺钉	Banjo bolt	1					
4	4RZT730003-1	管接螺钉	Banjo bolt	1		1			
5	RZ730004	回油管接头	Adapter,oil drain pipe	1					
6	495ZD-1-23002	回油法兰垫片	Gasket,oil drain flange	1					
	4R2ZG730008	回油法兰垫片	Gasket,oil drain flange			1			
7	4RZD730009	回油接管	Oil drain rubber hose	1					
	4R2ZG730009	回油接管	Oil drain rubber hose			1			
8	4RZ730011	增压器排气法兰	Exhaust flange,turbochager	1					
9	4RZ730012	增压器排气法兰垫片	Gasket,exhaust flange	1					
	4R2ZG730012	增压器排气法兰垫片	Gasket,exhaust flange			2			
10	4RZD730100	增压器部件	Turbocharger subassembly	1					
	4R2ZG730100	增压器部件	Turbocharger subassembly			1			
11	4R1ZD1730200	增压器进油管部件	Oil inlet pipe subassembly,turbocharger	1					
	4R2ZG730700	增压器进油管部件	Oil inlet pipe subassembly,turbocharger			1			

柴油机型号 Model	4RMZG8	4RMG25-1	4RNSG3	4RNG3	4RMAZG	6RMG20
----------------	--------	----------	--------	-------	--------	--------

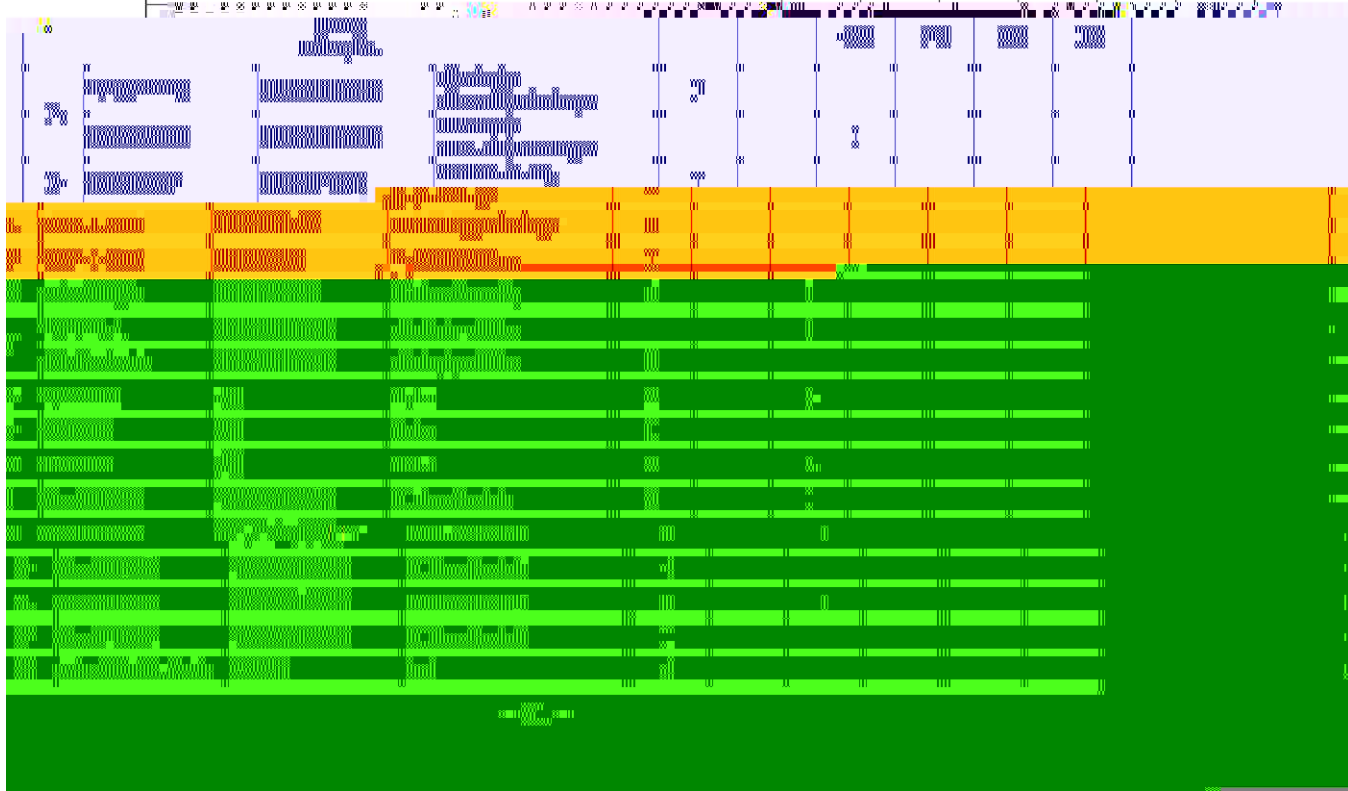

支架底座总成
BRACKET AND SUPPORT ASSEMBLY

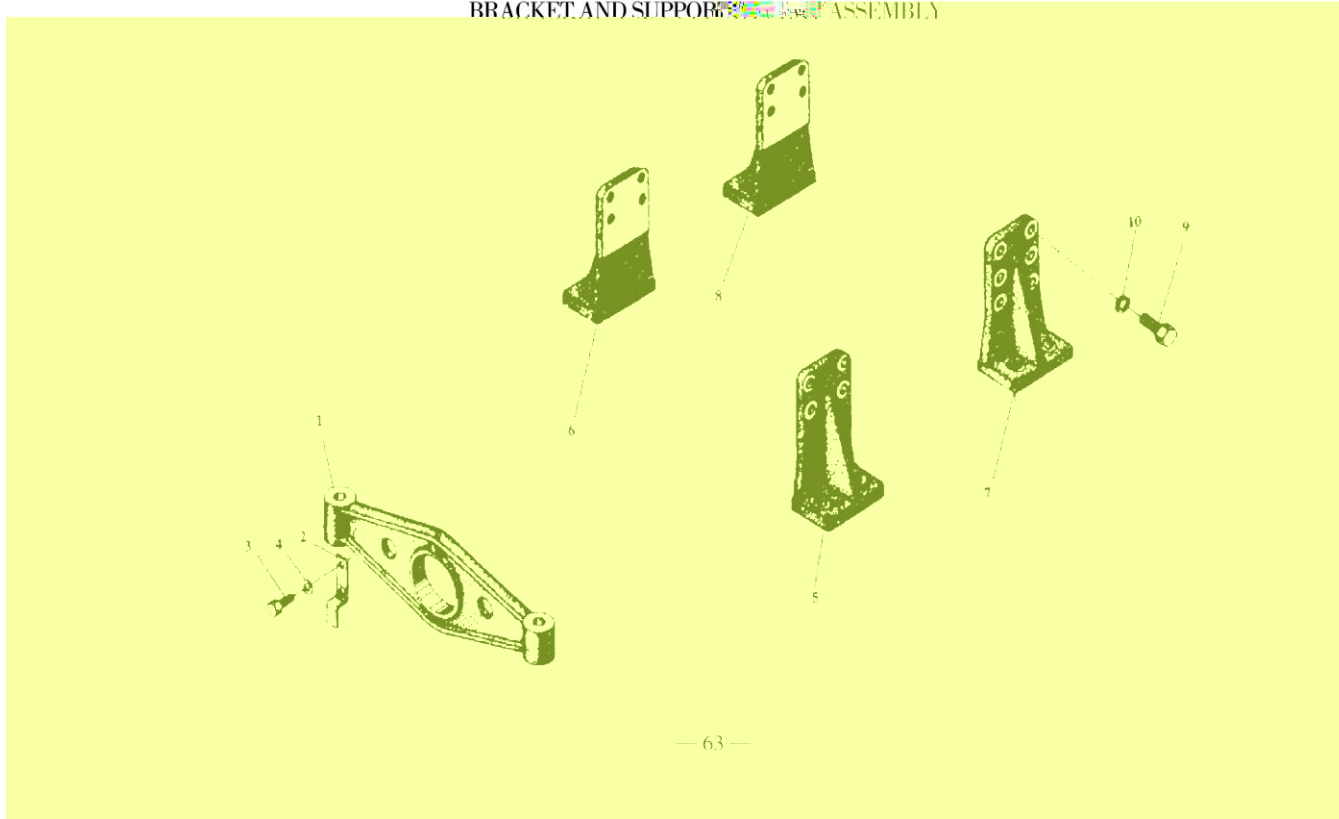

20. 支架底座总成
BRACKET AND SUPPORT SEAT ASSEMBLY

柴油机型号 Model				4RMZG8	4RMG25-1	4RNSG3	4RNG3	4RMAZG	6RMG20
供货号 Delivery No.						QZ2	XG1	QZ2	LZ2
1	4RG740001-1	前支座	Front support	1					
2	4R740002	限位板	Position limit plate	1					
3	M8x16GB5783	全螺纹六角头螺栓	Full thread hex bolt	2					
4	8GB848-140HV-Zn.D	小垫圈	Small washer	2					
5	RD920011	前支架	Front bracket	2	2	2	2		
	6R1G20740021	左前支架	Front, left bracket						1
	R920011-Y2	运输左前支架	Front, left transport bracket					1	
	6R1G20740022	右前支架	Front, right bracket						1
6	R920011-Y1	运输右前支架	Front, right transport bracket					1	
	RD920012	后支架	Rear bracket	2	2				
7	6R1G20740023	左后支架	Rear, left bracket						
	R920012-Y2	运输左后支架	Rear, left transport bracket						1
	6R1G20740024	右后支架	Rear, right bracket						1
	R920012-Y1	运输右后支架	Rear, right transport bracket						1
	R920012-QZ	运输左后支架	Rear, transport bracket				2	2	8
	M12x30GB5783	全螺纹六角头螺栓							
			Spring washer	16	16	12	12	8	16